

## HANGZHOU RUI YA ELECTRICAL APPLIANCE CO.,LTD--14 years OEM&ODM manufacturer

### GENERAL INFORMATION

The RY-100M desiccant dehumidifier is designed to efficiently dehumidify the air in crawl spaces, basements, and other tight areas. This design facilitates easy transport by one person. Furthermore, it's used for drying out buildings, new buildings as well as water damaged buildings. These dehumidifiers use desiccant to remove moisture from air that passes through them. They dry air more effectively in cold environments than refrigerant (or condensate) dehumidifiers.

### CONSTRUCTIONAL FEATURES

1. Sturdy housing in stainless steel
2. High performance at low temperatures and low relative humidity in a room.
3. Sweden Profute Silica gel adsorption wheel, washable, recycled, environmental protection
4. Automatic/manual mode, automatically ON/ OFF according to the room humidity
5. 1-24 hour timer switch
6. 485 communication interface



Model	RY-100M
Voltage	220V/60HZ
Rated power	0.7kw
Rated Current	3.4A
Dehumidification Capacity	0.36 kg/h at T=20°C; RH=60%
<b>Process air</b>	
Rated airflow	100m³/h
Available static pressure	50Pa
Blower motor power	0.068kw
Connection inlet Ø	100mm
Connection outlet Ø	70mm
<b>Reactivation air</b>	
Rated airflow	2.5m³/h
Available static pressure	30Pa
Blower motor power	0.045kw
Connection inlet Ø	70mm
Connection outlet Ø	70mm
<b>Dehumidification wheel</b>	
Wheel size	φ200x50mm
<b>Electric heating equipment</b>	
Heater power	0.68kw
<b>Other data</b>	
Operating temperature	-10/+55°C
Machine size	336*260*319mm
N.W	13kg
Protective class for whole	IP44
Protective class for electric	IP54
Filter	G4 (customizable)

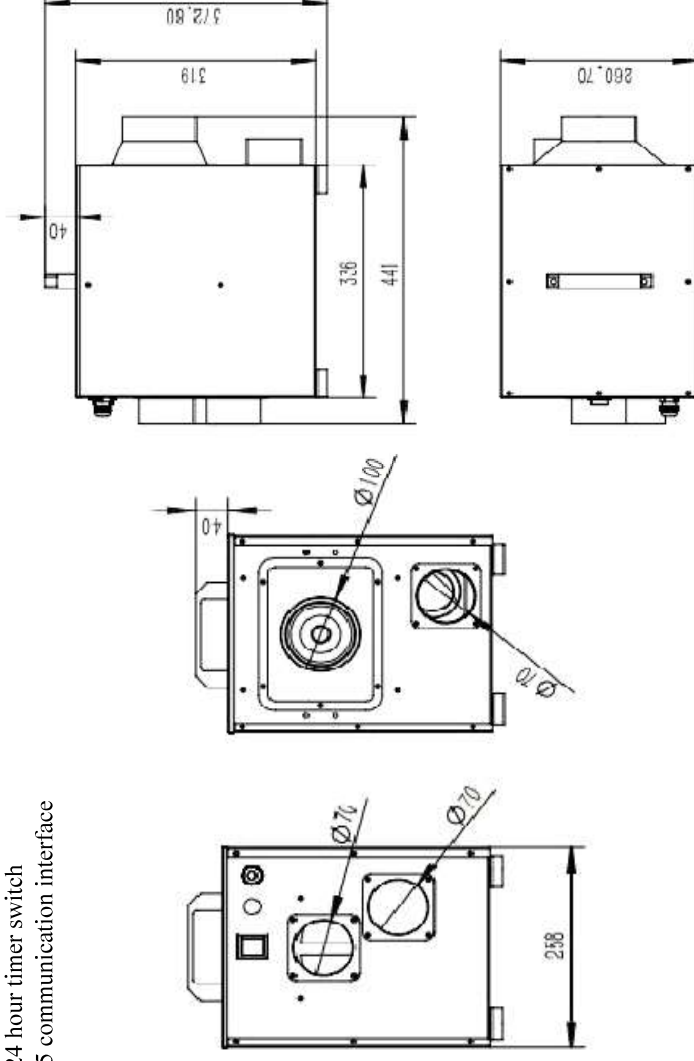



**GENERAL INFORMATION**  
 The RY-200M desiccant dehumidifier is designed to efficiently dehumidify the air in crawl spaces, basements, and other tight areas. This design facilitates easy transport by one person. Furthermore, it's used for drying out buildings, new buildings as well as water damaged buildings. These dehumidifiers use desiccant to remove moisture from air that passes through them. They dry air more effectively in cold environments than refrigerant (or condensate) dehumidifiers.

**CONSTRUCTIONAL FEATURES**

1. Sturdy housing in stainless steel
2. High performance at low temperatures and low relative humidity in a room.
3. Sweden Profute Silica gel adsorption wheel, washable, recycled, environmental protection
4. Automatic/manual mode, automatically ON/ OFF according to the room humidity
5. 1-24 hour timer switch
6. 485 communication interface

Model	RY-200M
Voltage	220V/60HZ
Rated power	0.79kw
Rated Current	3.6A
Dehumidification Capacity	0.65 kg/h at T=20°C; RH=60%
<b>Process air</b>	
Rated airflow	200m³/h
Available static pressure	50Pa
Blower motor power	0.08kw
Connection inlet Ø	150mm
Connection outlet Ø	100mm
<b>Reactivation air</b>	
Rated airflow	50m³/h
Available static pressure	40Pa
Blower motor power	No
Connection inlet Ø	70mm
Connection outlet Ø	No
<b>Dehumidification wheel</b>	
Wheel size	φ200x80mm
<b>Electric heating equipment</b>	
Heater power	0.7kw
<b>Other data</b>	
Operating temperature	-10/+55°C
Machine size	344*297*340mm
N.W	13.5kg
Protective class for whole	IP44
Protective class for electric	IP54
Filter	G4 (customizable)

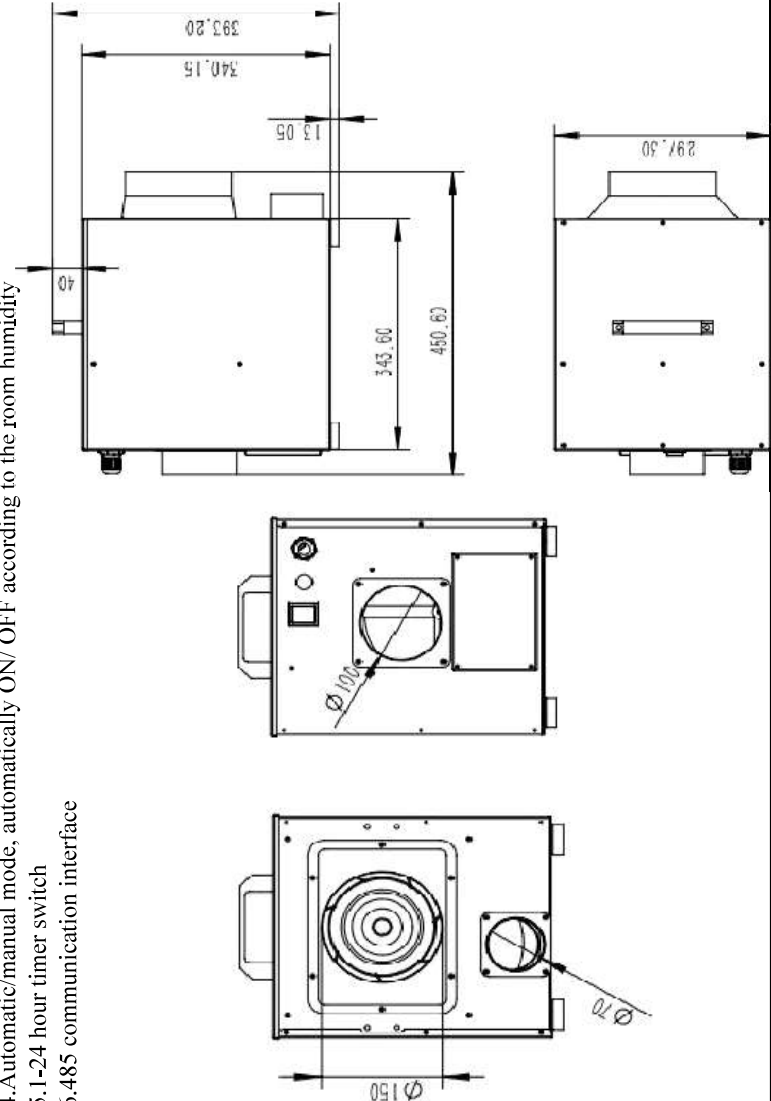

Model	RY-300M
Voltage	220V/60HZ
Rated power	2kw
Rated current	9A
Dehumidification Capacity	2kg/h at T=20°C; RH=60%
<b>Process air</b>	
Rated airflow	320m³/h
External residual pressure	80Pa
Connection inlet Ø	125mm
Connection outlet Ø	125mm
<b>Reactivation air</b>	
Rated airflow	110m³/h
External residual pressure	50Pa
Connection inlet Ø	80mm
Connection outlet Ø	80mm
<b>Other data</b>	
Operating temperature	-10/+50°C
Machine size	680*425*400mm
Weight (packaging excluded)	32kg
Filter	G4 (customizable)

### CONSTRUCTIONAL FEATURES

1. Sturdy housing in stainless steel
2. High performance at low temperatures and low relative humidity in a room.
3. Sweden Profolute Silica gel adsorption wheel, washable, recycled, environmental protection
4. Automatic/manual mode, automatically ON/ OFF according to the room humidity
5. 1-24 hour timer switch
6. 485 communication interface

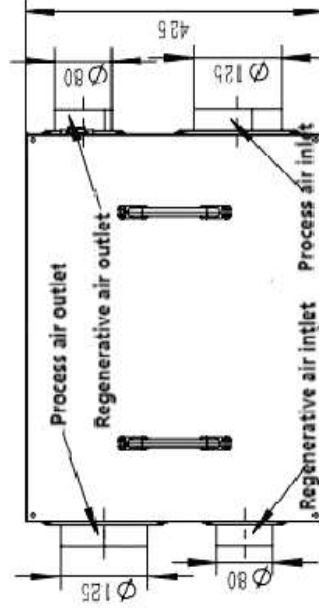
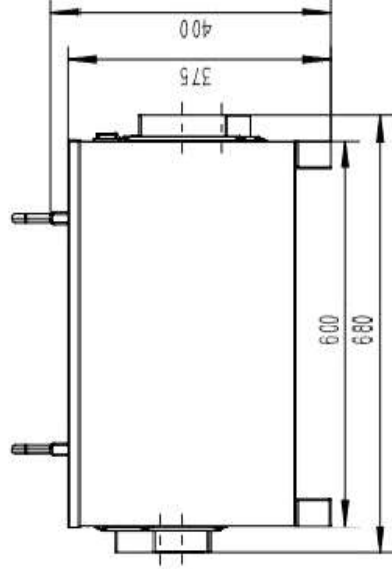
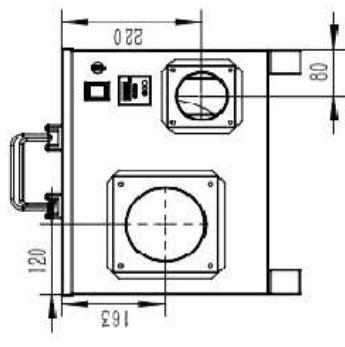
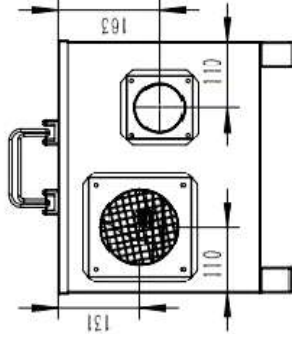

Model	RY-600M
Voltage	220V/60HZ
Rated power	4.5kw
Rated current	20A
Dehumidification Capacity	3kg/h at T=20°C; RH=60%
<b>Process air</b>	
Rated airflow	580m³/h
External residual pressure	100Pa
Connection inlet Ø	125mm
Connection outlet Ø	125mm
<b>Reactivation air</b>	
Rated airflow	200m³/h
External residual pressure	70Pa
Connection inlet Ø	100mm
Connection outlet Ø	100mm
<b>Other data</b>	
Operating temperature	-10/+50°C
Machine size	585*420*866mm
Weight (packaging excluded)	55kg
Filter	G4 (customizable)

### CONSTRUCTIONAL FEATURES

1. Sturdy housing in stainless steel
2. High performance at low temperatures and low relative humidity in a room.
3. Sweden Profolute Silica gel adsorption wheel, washable, recycled, environmental protection
4. Automatic/manual mode, automatically ON/ OFF according to the room humidity
5. 1-24 hour timer switch
6. 485 communication interface

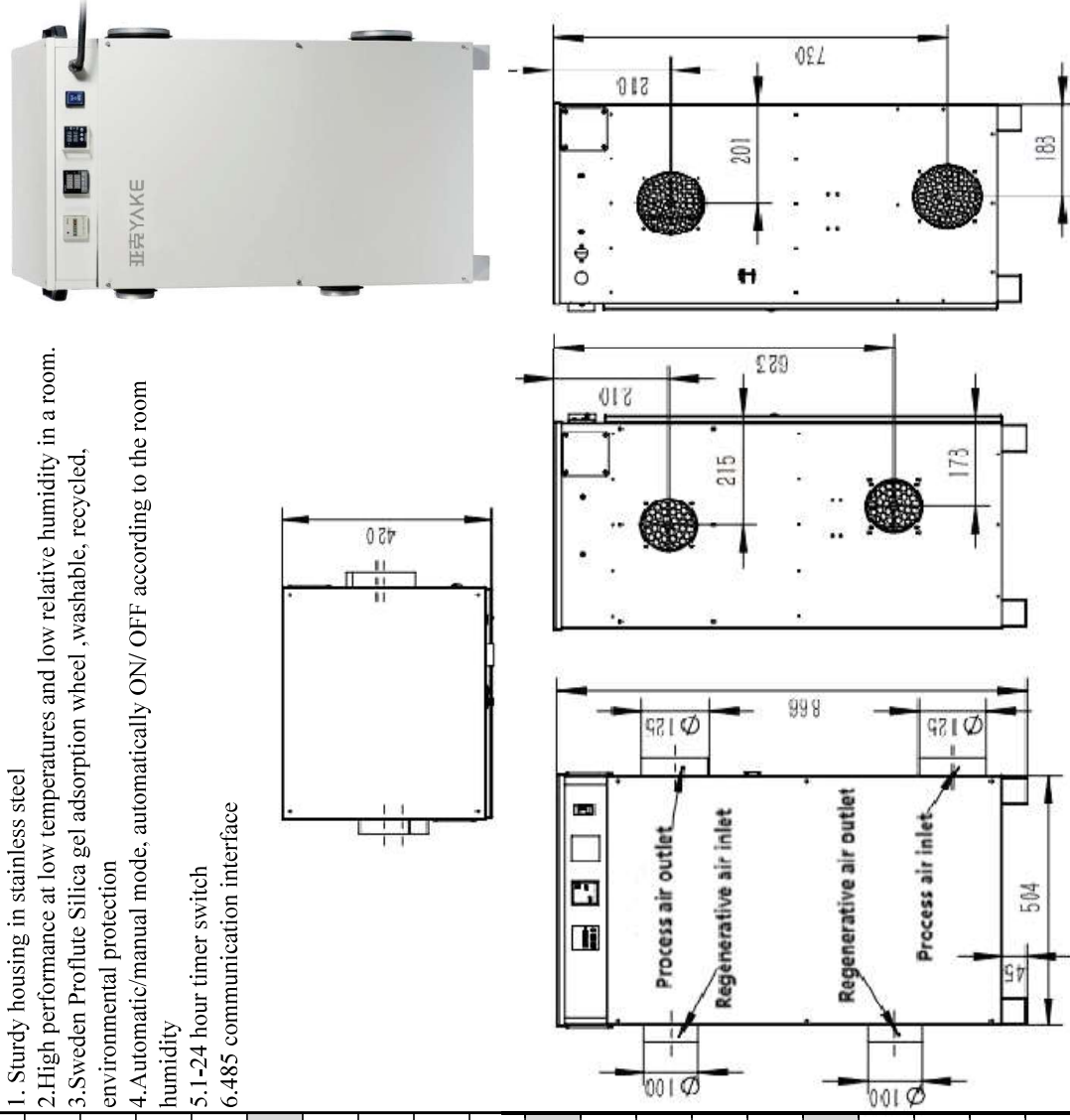

Model	RY-750M
Voltage	380V/60HZ
Rated power	7kw
Rated current	14A
Dehumidification Capacity	4.5kg/h at T=20°C; RH=60%
<b>Process air</b>	
Rated airflow	750m³/h
External residual pressure	120Pa
Connection inlet Ø	200mm
Connection outlet Ø	200mm
<b>Reactivation air</b>	
Rated airflow	250m³/h
External residual pressure	80Pa
Connection inlet Ø	125mm
Connection outlet Ø	125mm
<b>Other data</b>	
Operating temperature	-10/+50°C
Machine size	1090*600*671mm
Weight (packaging excluded)	90kg
Filter	G4 (customizable)

### CONSTRUCTIONAL FEATURES

1. Sturdy housing in stainless steel
2. High performance at low temperatures and low relative humidity in a room.
3. Sweden Profolute Silica gel adsorption wheel, washable, recycled, environmental protection
4. Automatic/manual mode, automatically ON/ OFF according to the room humidity
5. 1-24 hour timer switch
6. 485 communication interface

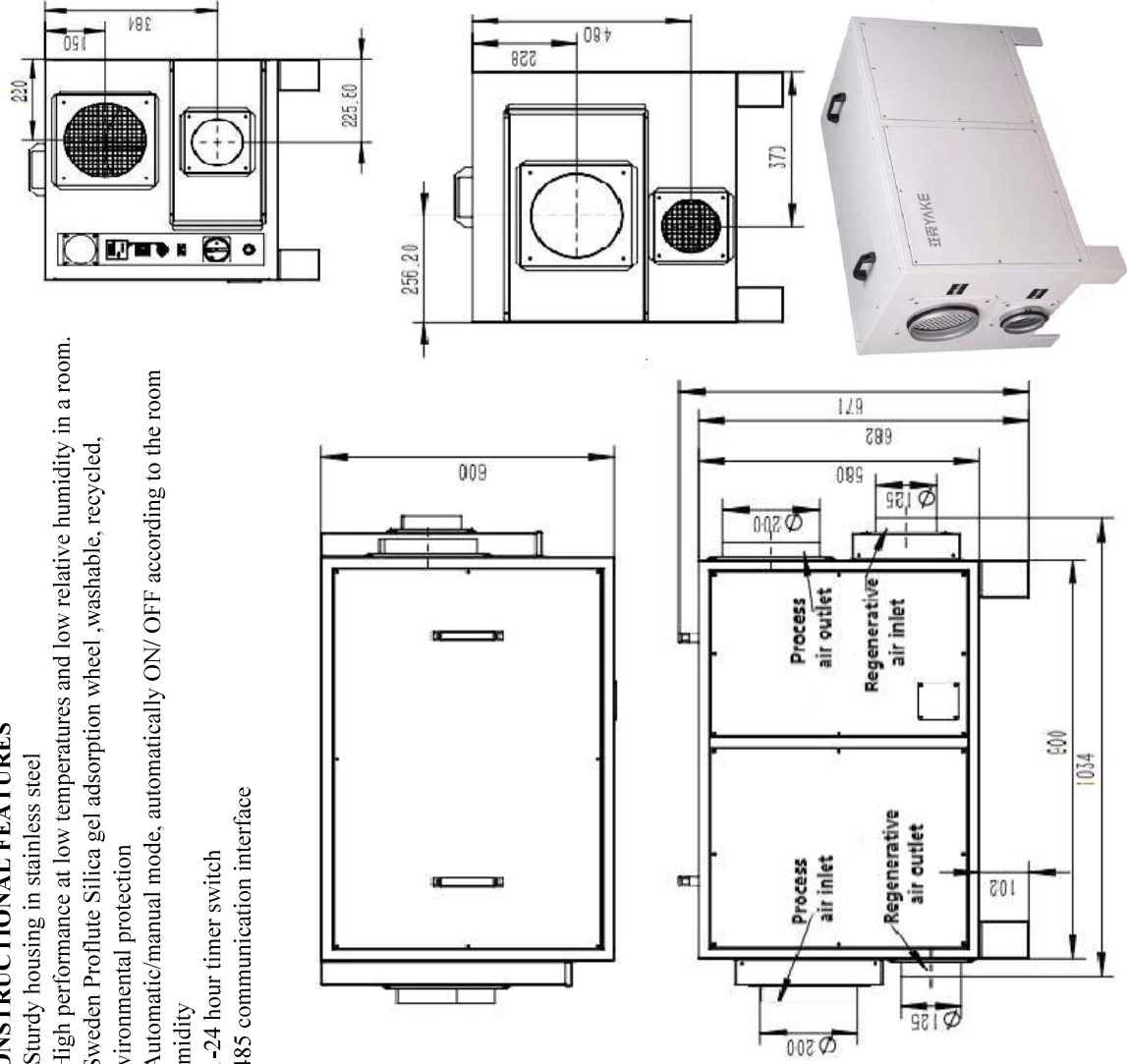

Model	RY-800M
Voltage	380V/60HZ
Rated power	10kw
Rated current	16A
Dehumidification Capacity	6 kg/h at T=20°C; RH=60%
<b>Process air</b>	
Rated airflow	850m³/h
External residual pressure	150Pa
Connection inlet Ø	200mm
Connection outlet Ø	200mm
<b>Reactivation air</b>	
Rated airflow	260m³/h
External residual pressure	100Pa
Connection inlet Ø	150mm
Connection outlet Ø	150mm
<b>Other data</b>	
Operating temperature	-10/+50°C
Machine size	875*640*1232mm
Weight (packaging excluded)	150kg
Filter	G4 (customizable)

**CONSTRUCTIONAL FEATURES**

1. Sturdy housing in stainless steel
2. High performance at low temperatures and low relative humidity in a room.
3. Sweden Profolute Silica gel adsorption wheel, washable, recycled, environmental protection
4. Automatic/manual mode, automatically ON/ OFF according to the room humidity
5. 1-24 hour timer switch
6. 485 communication interface

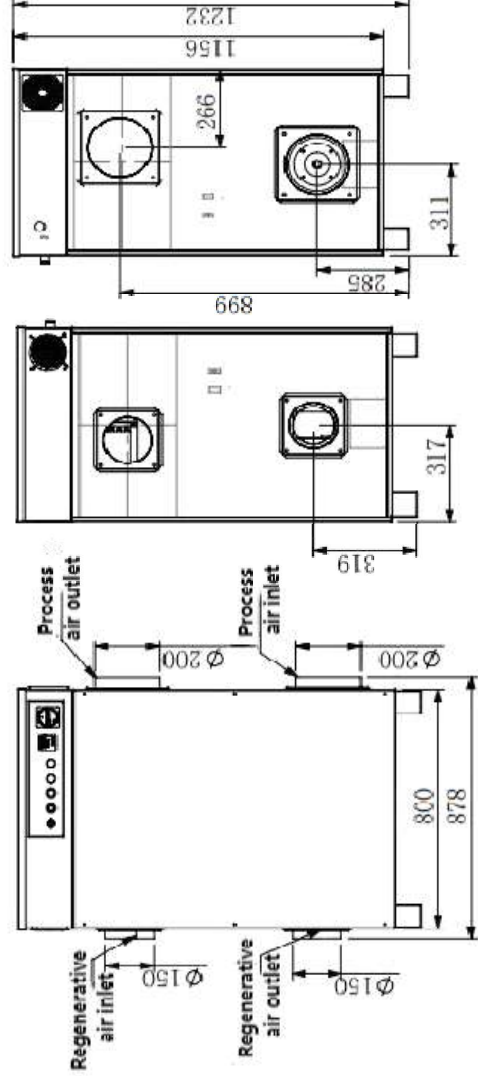
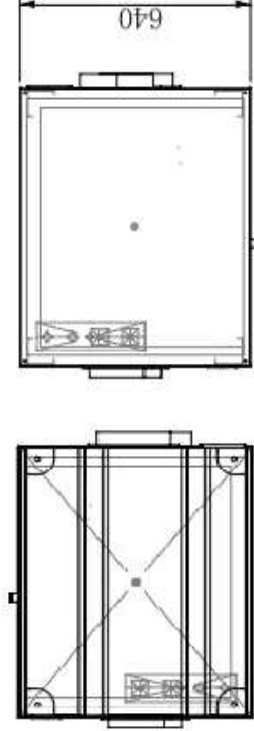

Model	RY-1000M
Voltage	380V/60HZ
Rated power	11kw
Rated current	18A
Dehumidification Capacity	7.5kg/h at T=20°C; RH=60%
<b>Process air</b>	
Rated airflow	1100m³/h
External residual pressure	150Pa
Connection inlet Ø	200mm
Connection outlet Ø	200mm
<b>Reactivation air</b>	
Rated airflow	400m³/h
External residual pressure	100Pa
Connection inlet Ø	150mm
Connection outlet Ø	150mm
<b>Other data</b>	
Operating temperature	-10/+50°C
Machine size	875*640*1232mm
Weight (packaging excluded)	140kg
Filter	G4 (customizable)

**CONSTRUCTIONAL FEATURES**

1. Sturdy housing in stainless steel
2. High performance at low temperatures and low relative humidity in a room.
3. Sweden Profolute Silica gel adsorption wheel, washable, recycled, environmental protection
4. Automatic/manual mode, automatically ON/ OFF according to the room humidity
5. 1-24 hour timer switch
6. 485 communication interface

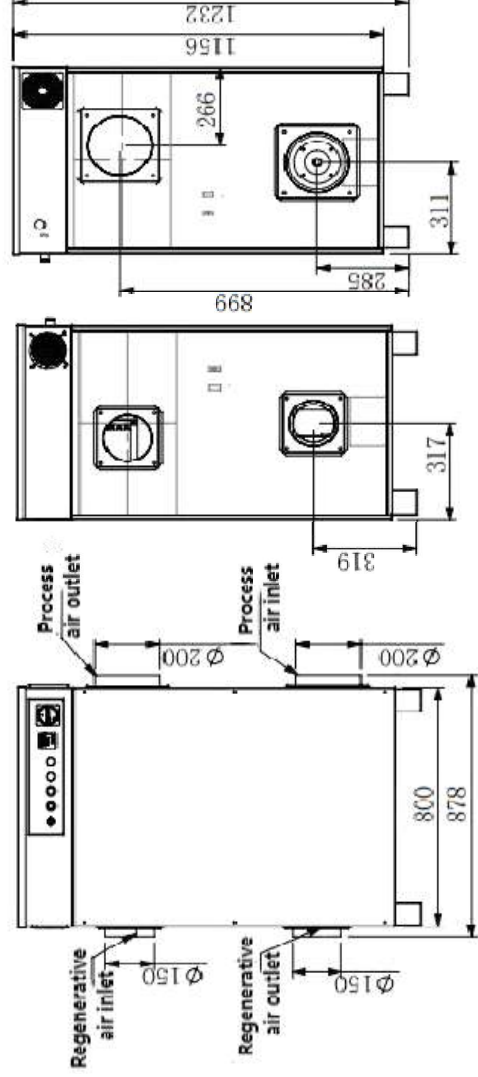
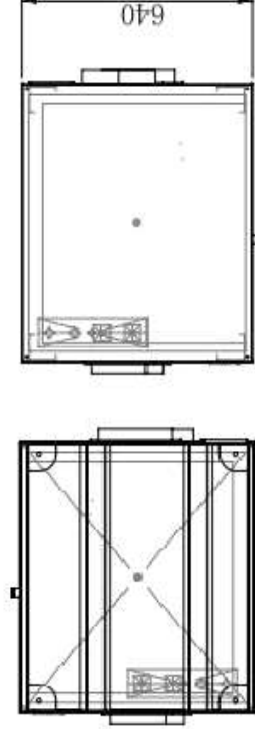

Model	RY-1200M
Voltage	380V/60HZ
Rated power	13kw
Rated current	20.5A
Dehumidification Capacity	8.5kg/h at T=20°C; RH=60%
<b>Process air</b>	
Rated airflow	1250m <sup>3</sup> /h
External residual pressure	200Pa
Connection inlet Ø	250mm
Connection outlet Ø	250mm
<b>Reactivation air</b>	
Rated airflow	450m <sup>3</sup> /h
External residual pressure	150Pa
Connection inlet Ø	160mm
Connection outlet Ø	160mm
<b>Other data</b>	
Operating temperature	-10/+50°C
Machine size	880*678*1238mm
Weight (packaging excluded)	155kg
Filter	G4 (customizable)

#### CONSTRUCTIONAL FEATURES

1. Sturdy housing in stainless steel
2. High performance at low temperatures and low relative humidity in a room.
3. Sweden Profolute Silica gel adsorption wheel, washable, recycled, environmental protection
4. Automatic/manual mode, automatically ON/ OFF according to the room humidity
5. 1-24 hour timer switch
6. 485 communication interface



Model	RY-1500M
Voltage	380V/60HZ
Rated power	15kw
Rated current	26A
Dehumidification Capacity	10kg/h at T=20°C; RH=60%
<b>Process air</b>	
Rated airflow	1550m <sup>3</sup> /h
External residual pressure	200Pa
Connection inlet Ø	250mm
Connection outlet Ø	250mm
<b>Reactivation air</b>	
Rated airflow	580m <sup>3</sup> /h
External residual pressure	150Pa
Connection inlet Ø	160mm
Connection outlet Ø	160mm
<b>Other data</b>	
Operating temperature	-10/+50°C
Machine size	880*678*1238mm
Weight (packaging excluded)	157kg
Filter	G4 (customizable)

#### CONSTRUCTIONAL FEATURES

1. Sturdy housing in stainless steel
2. High performance at low temperatures and low relative humidity in a room.
3. Sweden Profolute Silica gel adsorption wheel, washable, recycled, environmental protection
4. Automatic/manual mode, automatically ON/ OFF according to the room humidity
5. 1-24 hour timer switch
6. 485 communication interface

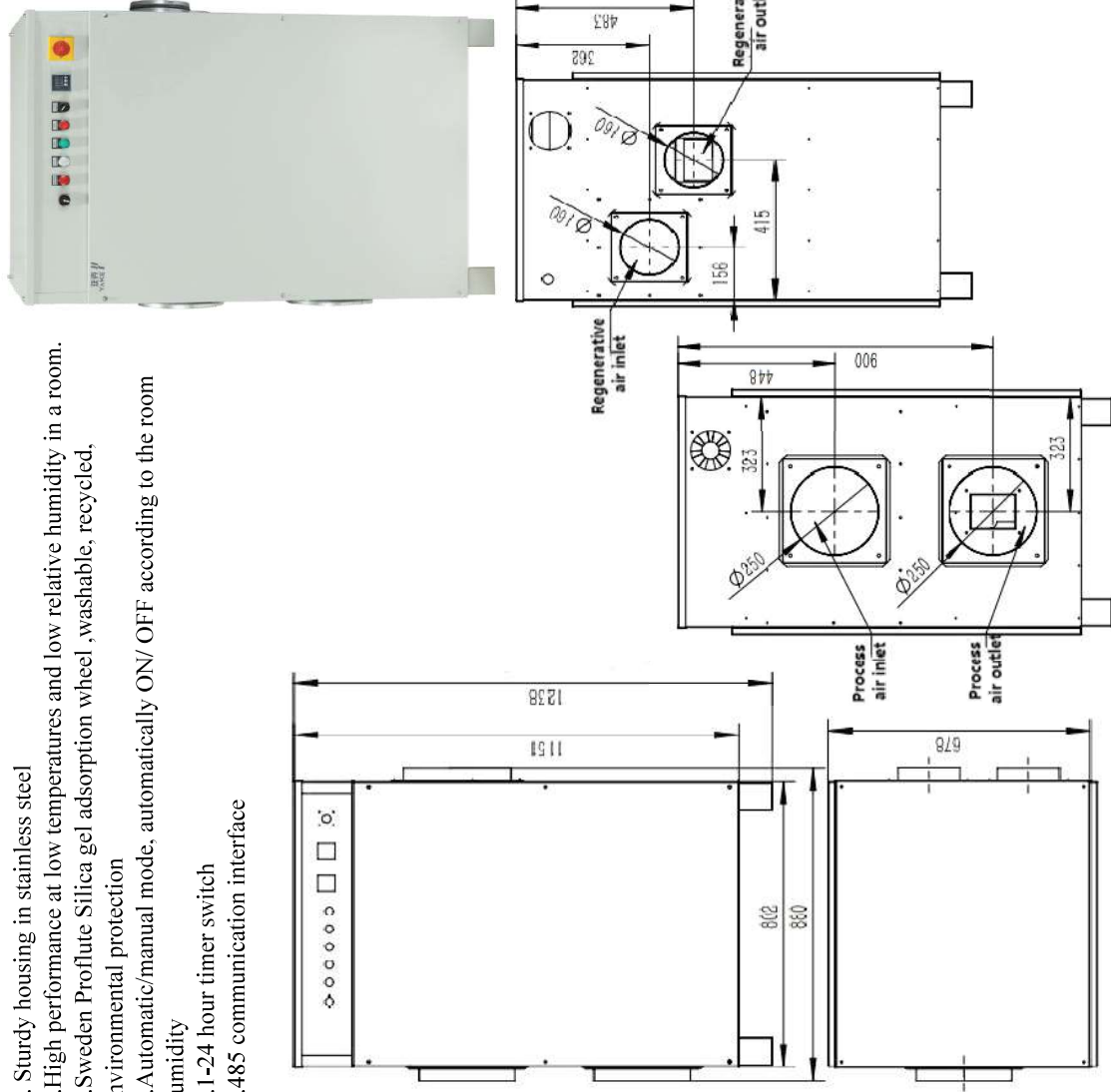

Model	RY-2500M
Voltage	380V/60HZ
Rated power	24kw
Rated current	37.5A
Dehumidification Capacity	15kg/h at T=20°C; RH=60%
<b>Process air</b>	
Rated airflow	2500m³/h
External residual pressure	400Pa
Connection inlet Ø	522*286mm/Ø400mm
Connection outlet Ø	400mm
<b>Reactivation air</b>	
Rated airflow	925m³/h
External residual pressure	200Pa
Connection inlet Ø	200mm
Connection outlet Ø	200mm
<b>Other data</b>	
Operating temperature	-10/+50°C
Machine size	1312*856*1300mm
Net Weight	290kg
Filter	G4 (customizable)

**CONSTRUCTIONAL FEATURES**

1. Sturdy housing in stainless steel
2. High performance at low temperatures and low relative humidity in a room.
3. Sweden Profolute Silica gel adsorption wheel, washable, recycled, environmental protection
4. Automatic/manual mode, automatically ON/ OFF according to the room humidity
5. 1-24 hour timer switch
6. 485 communication interface

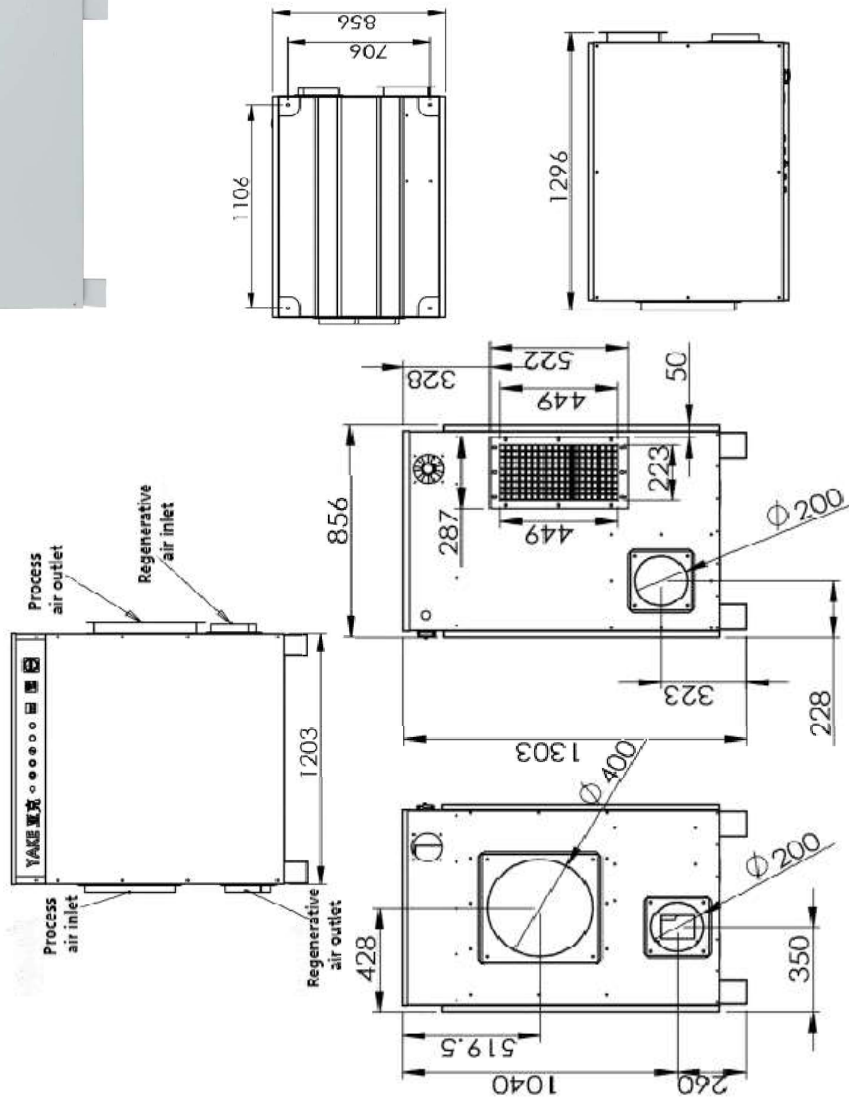

Model	RY-3000M
Voltage	380V/60HZ
Rated power	30kw
Rated current	50A
Dehumidification Capacity	19kg/h at T=20°C; RH=60%
<b>Process air</b>	
Rated airflow	3000m <sup>3</sup> /h
External residual pressure	400Pa
Connection inlet Ø	522*286mm
Connection outlet Ø	400mm
<b>Reactivation air</b>	
Rated airflow	1100m <sup>3</sup> /h
External residual pressure	200Pa
Connection inlet Ø	200mm
Connection outlet Ø	200mm
<b>Other data</b>	
Operating temperature	-10/+50°C
Machine size	1312*856*1300mm
Weight (packaging excluded)	295kg
Filter	G4 (customizable)

#### CONSTRUCTIONAL FEATURES

1. Sturdy housing in stainless steel
2. High performance at low temperatures and low relative humidity in a room.
3. Sweden Profolute Silica gel adsorption wheel, washable, recycled, environmental protection
4. Automatic/manual mode, automatically ON/ OFF according to the room humidity
5. 1-24 hour timer switch
6. 485 communication interface

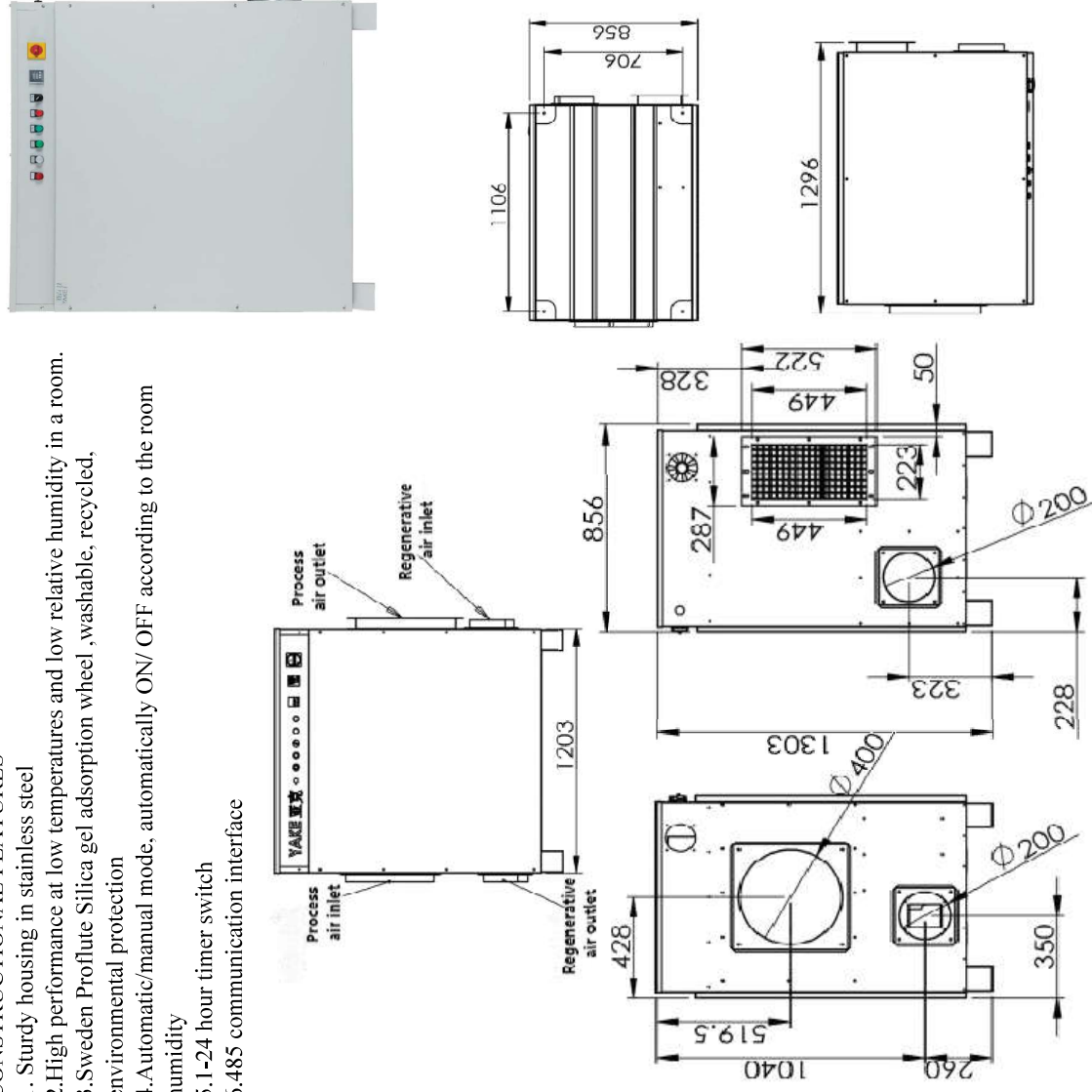

# Hangzhou Rui Ya Electrical Appliance Co.,Ltd.

No.10 Kangzhong Rd. Gongshu District Hangzhou Zhejiang

## Small Ultrasonic Humidifier

<b>Model</b>	<b>RYJS-03D</b>	<b>RYJS-06D</b>	<b>RYJS-09D</b>	<b>RYJS-12D</b>
<b>Capacity</b>	3KG/H	6KG/H	9KG/H	12KG/H
<b>Fog particles</b>	≤10µm			
<b>Voltage</b>	220V/60Hz			
<b>Power</b>	235W	325W	565W	655W
<b>Air Volume</b>	153m³/h	310m³/h	352m³/h	680m³/h
<b>Atomizer quantity</b>	1pc M0604-3	1pc M0608	1pc M0604-3+1pc M0608	
<b>Steam Vent</b>	110mm*1pc	110mm*2pcs	110mm*2pcs	
<b>Product Size</b>	509*385*306mm			
<b>Product Weight</b>	16.5kg	18kg	21kg	22.5kg
<b>Control way</b>	Microcomputer controlling			
<b>Package</b>	Carton Package			
<b>Package size</b>	590*470*520mm			
<b>Warranty time</b>	Within 1 year after you receiving the machine			

1, Intelligent and accurate humidity controlling, adopting standard integrated mist module, stable and easy maintenance.

2, Diameter of fog output is only 1-10um.

3, Membrane digital control; LED Display; Timer; Power off memory.

4, Automatic water inlet system: When the water level in the water tank is lower than the required water level, the water tank will be automatically refilled. And the water inlet will automatically stop when the water level in the water tank rises to the limit water level.

5, Automatic control: when the ambient humidity reaches the set value, it will automatically stop humidification, the fan will delay 30s. When the current ambient humidity is lower than the set value, automatically start humidification, the set humidity range is adjustable from 10-95%.

6, The external humidity sensor can be installed separately from the machine to prevent the machine from being exposed to high humidity for a long time.





### Live pictures

			
RYJS-03D	RYJS-06D	RYJS-09D	RYJS-12D

## Hangzhou Rui Ya Electrical Appliance Co.,Ltd.

No.10 Kangzhong Rd. Gongshu District Hangzhou, Zhejiang

### Large Ultrasonic Humidifier

Model	RYJS-15D	RYJS-18D	RYJS-21D	RYJS-24D	RYJS-30D	RYJS-36D	RYJS-42D	RYJS-48D	RYJS-54D	RYJS-60D	RYJS-66D	RYJS-72D	RYJS-78D	RYJS-84D	RYJS-90D	RYJS-96D	RYJS-102D						
Capacity	15KG/H	18KG/H	21KG/H	24KG/H	30KG/H	36KG/H	42KG/H	48KG/H	54KG/H	60KG/H	66KG/H	72KG/H	78KG/H	84KG/H	90KG/H	96KG/H	102KG/H						
Fog particles	≤10µm																						
Voltage	220V/60Hz																						
Power	1500W	1800W	2100W	2400W	3000W	3600W	4200W	4800W	5400W	6000W	6600W	7200W	7800W	8400W	9000W	9600W	10200W						
Stream Vent	110mm*2pcs																						
Size	550*420*470mm																						
Weight	30kg	32kg	34kg	38kg	40kg	42kg	44kg	55kg	58kg	62kg	65kg	75kg	80kg	83kg	90kg	95kg	100kg						
Control way	Microcomputer controlling																						
Package	Plywood case																						
Package size	660*500*660mm																						
Warranty time	Within 1 year after you receiving the machine																						
Features	1, Intelligent and accurate humidity controlling, adopting standard integrated mist module, stable and easy maintenance.																						
	2, Diameter of fog output is only 1-10um.																						
	3, Membrane digital control; LED Display; Timer; Power off memory.																						
	4, Automatic water inlet system: When the water level in the water tank is lower than the required water level, the water tank will be automatically refilled. And the water inlet will automatically stop when the water level in the water tank rises to the limit water level.																						
	5, Automatic control: when the ambient humidity reaches the set value, it will automatically stop humidification, the fan will delay 30s. When the current ambient humidity is lower than the set value, automatically start humidification, the set humidity range is adjustable from 10-95%.																						
	6, The external humidity sensor can be installed separately from the machine to prevent the machine from being exposed to high humidity for a long time.																						
<b>Live pictures</b>																							
																							
RYJS-15D / RYJS-18D / RYJS-21D						RYJS-24D / RYJS-30D / RYJS-36D / RYJS-42D						RYJS-48D / RYJS-54D / RYJS-60D						RYJS-66D/72D/78D/84D/90D/96D/102D					